



Tekform Slimline Drawer

2018

Important Information

Technical information

While every effort has been made in the production of this catalogue to ensure the accuracy of information, our products are continually being revised and users should confirm the up to date specification before ordering. Due to constant improvement of products presented in the catalogue, we can make changes at any time and without notice.

Responsibility

It is the responsibility of the user to ensure the fitness of hardware for the intended purpose. We recommend assessment by appropriate testing in the application and by technical enquiry to our representatives.

Intellectual property

Titus Group owns the intellectual property rights in its products worldwide whether as trademarks, patents, intellectual, copyright, designs, illustrations, drawings and the 'know-how' contained in their design and production. Titus Group respects the equivalent rights in competitors and all other relevant product design rights. To our knowledge our products do not infringe any intellectual property rights of competitors or other parties. Titus Group takes infringements of its rights seriously and will rigorously defend these rights to the full extent of the law.

*Non-preferred articles

All Item numbers in the catalogue marked with * are for non preferred items available on extended delivery times.

Trademarks

Titus and Titusonic are registered trademarks of Titus International Ltd. Lama is a registered trademark of Titus d.o.o. Dekani, WoodWelding is a registered trademark of WW SA.

Tekform Slimline Drawer

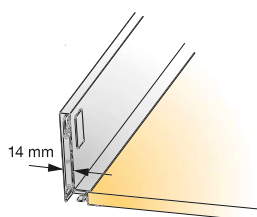

Narrow sides

- Sleek look with 14mm thickness
- Efficient utilisation of drawer space

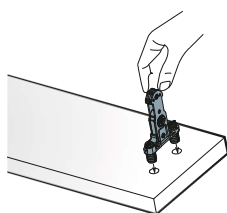

'EasyFix' front panel connector

- Hand insertion
- Quarter turn lock
- Repeatable assembly and disassembly possible

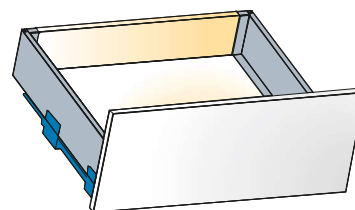

Flexibility of runner system

- Same machinery settings as Tekform Double Wall Drawer
- Same drilling specifications as Tekform Double Wall Drawer

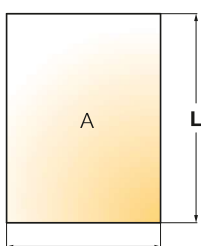

bottom panel width
tolerance +/- 1mm

Expanded tolerances

- Precise drawer alignment
- Smooth and silent operation
- Improved drawer stability in open position
- +/-1mm tolerance on bottom panel width size



Titus damper inside

- Life-long consistent soft closing performance at various closing speeds
- 'ConfidentClose' - fast closing, late start deceleration action, quiet landing
- Low pull-out force

Tekform Slimline Drawer

Product Guide

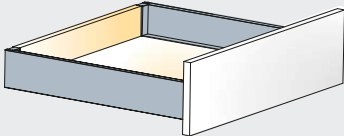
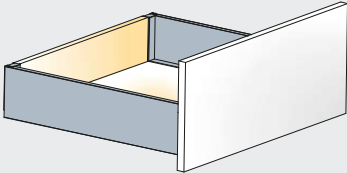
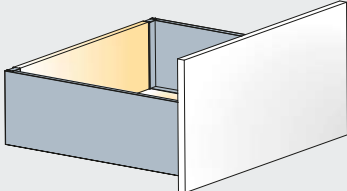
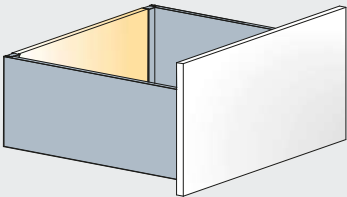
	Page
Tekform Slimline Drawer	
Tekform Slimline Drawer DW70	14
	
Tekform Slimline Drawer DW100	16
	
Tekform Slimline Drawer DW145	18
	
Tekform Slimline Drawer DW182	20
	

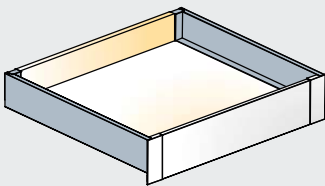
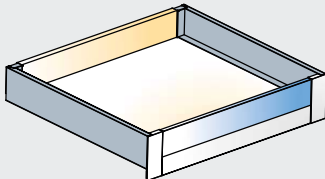
Inner Slimline Drawer Fronts	
Inner drawer front for Tekform Slimline Drawer DW70	22
	
Inner drawer front for Tekform Slimline Drawer DW70 with glass	24
	

Inner drawer front for
Tekform Slimline Drawer
DW145 with bar

26

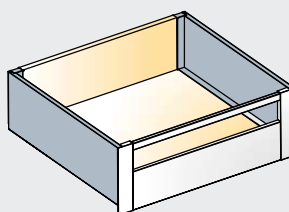

Inner drawer front for
Tekform slimline Drawer
DW145 with glass

28

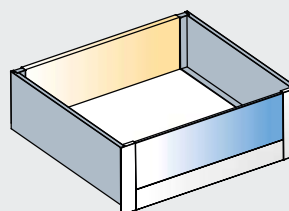

Inner drawer front for
Tekform Slimline Drawer
DW182 with bar

30

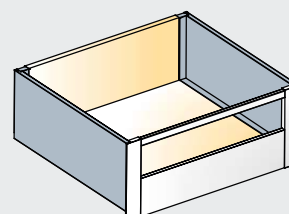

Inner drawer front for
Tekform Slimline Drawer
DW182 with glass

32

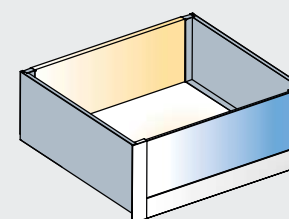

Tekform Slimline Drawer

Information

Technical Guide

How to choose the appropriate drawer dimension?

Select the drawer size based on available cabinet space. Please refer to the chart below with indicated minimum space

required in cabinet to choose appropriate drawer system.

Tekform Drawer nominal length (NL) in mm

NL	270	300	350	400	450	500	550
----	-----	-----	-----	-----	-----	-----	-----

	Tekform Drawer	
	Min. height (H) required	Cabinet depth (D)
Tekform Slimline Drawer DW70	115mm	NL+min 3mm
Tekform Slimline Drawer DW100	147mm	NL+min 3mm
Tekform Slimline Drawer DW145	198mm	NL+min 3mm
Tekform Slimline Drawer DW182	230mm	NL+min 3mm

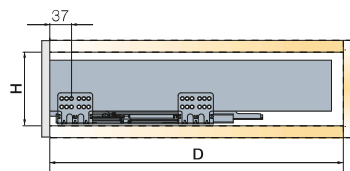

How to fix drawer sides to the front panel?



'EasyFix' front connector

The Tekform Drawer is available with 'EasyFix' or screw-in front connectors.

- Hand insertion
- Quarter turn locking system
- Expandable plastic dowel
- Easy assembly and disassembly of front panel

Front connector

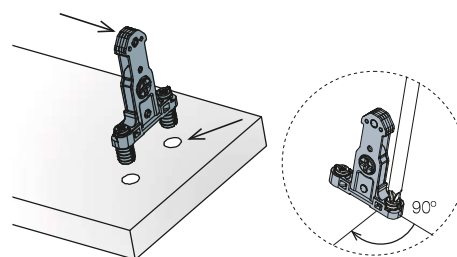

Screw-in front connector

- Reliable connection
- Fixing with Ø3.5x15mm screw (screws are not included)

Front connector

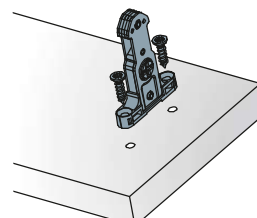

Bottom panel and back panel cutting dimensions

Dimensions of bottom and back panel depends on:

- cabinet width
- nominal drawer length
- drawer height

Tekform Drawer nominal length (NL) in mm

NL	270	300	350	400	450	500	550
----	-----	-----	-----	-----	-----	-----	-----

Cabinet width

ECW: External cabinet width
ICW: Internal cabinet width
NL: Nominal length of drawer

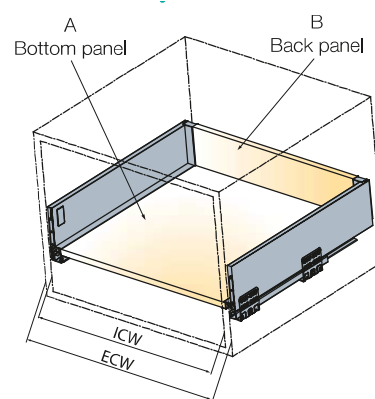

Back panel cutting dimensions

Back panel height depends on the selected drawer height:

	H back panel
SDW70	68
SDW100	100
SDW145	151
SDW182	183

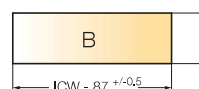

Bottom panel cutting dimensions

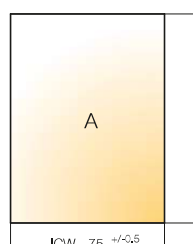

NL	270	300	350	400	450	500	550
L	260	290	340	390	440	490	540

NL= Tekform Drawer nominal length (in mm)

Tekform Slimline Drawer Information

Technical Guide

How to choose the appropriate drawer runner fixing positions?

Drawer fixing positions depend on the chosen drawer front type.

Tekform Slimline Drawer with standard front

When a standard drawer front is applied, use the third hole on the drawer runner for fixing.

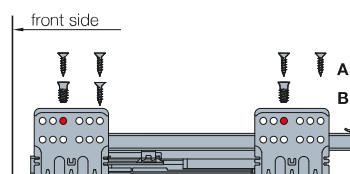

Tekform Slimline Drawer with inner front

When an inner drawer front is applied, use the second hole on the drawer runner for fixing.

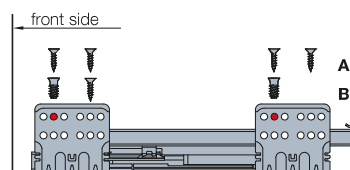

Load capacity

Drawer load capacity is 40 kg.

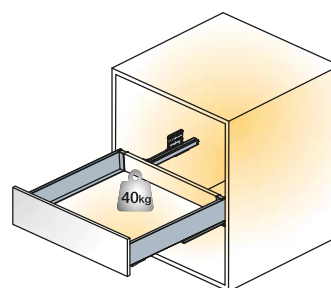

Expanded tolerances

Tekform drawers provide expanded tolerances in cabinet construction and assure:

- precise drawer alignment
- smooth and silent operating
- improved drawer stability in open position
- Tekform drawers provide tolerance of +/-1mm on bottom panel width size

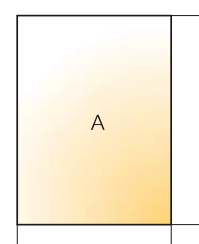

bottom panel width tolerance +/- 1mm



Adjustment needs to be done on both sides of the drawer

Adjustments

Side adjustment

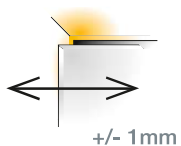

Side adjustment is done via the adjustment screw on the drawer side.

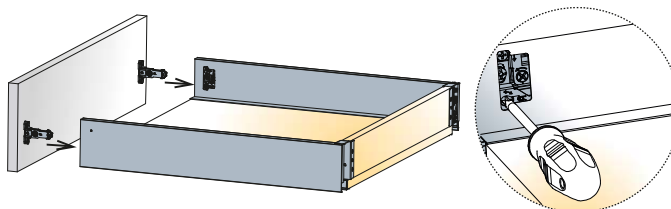

Height adjustment

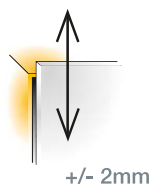

Height adjustment is done via the cam. First, release the locking screw and tighten it back after the front is adjusted.

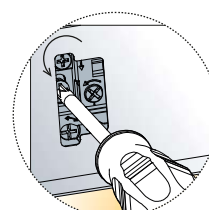
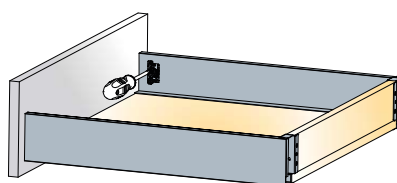

Release

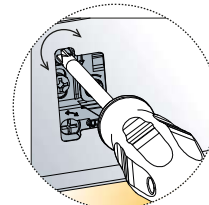
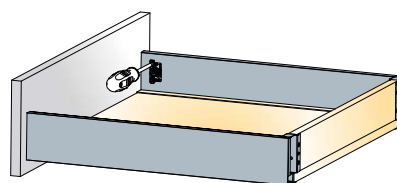

Adjust

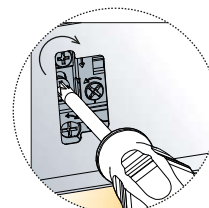
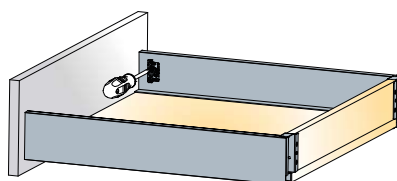

Tighten

Key Design Choices

'ConfidentClose'

Fast closing

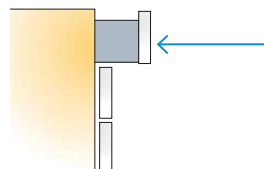

Late start of deceleration action

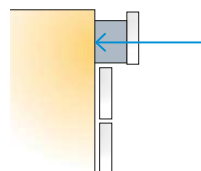

Quiet landing

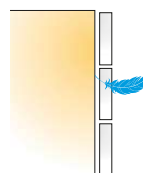

CAF Consumer Assembly Friendliness

'EasyFix' front panel connector with expandable plastic dowel provides:

- quick, tool-free insertion
- quarter turn lock
- repeatable assembly and disassembly

Front connector

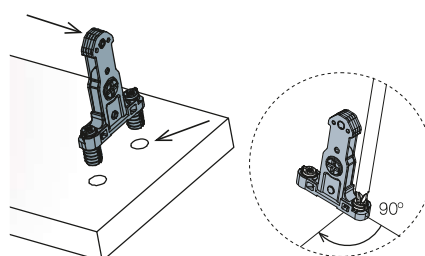

Titus hydraulic damper

Designed and produced in-house.

- Reliable and consistent life-long damping
- Smooth closing
- Dampers' consistency over high volume production runs assured
- 100% automated quality check



Damping action

Even and smooth soft closing action.

- Soft and reliable closing

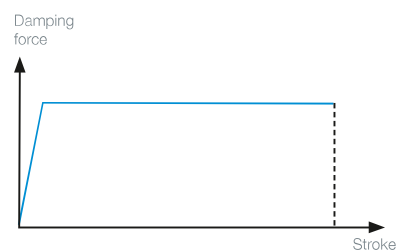

Tekform Slimline Drawer DW70

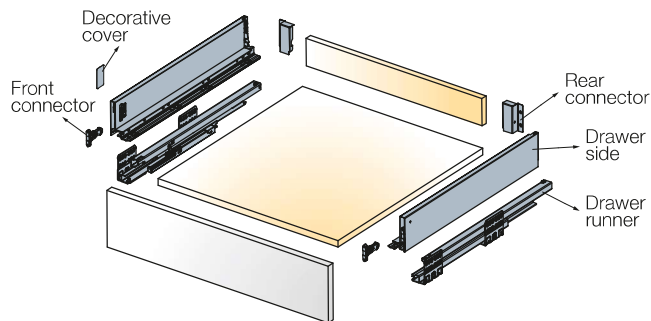
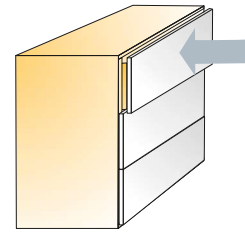

Cutting dimensions details

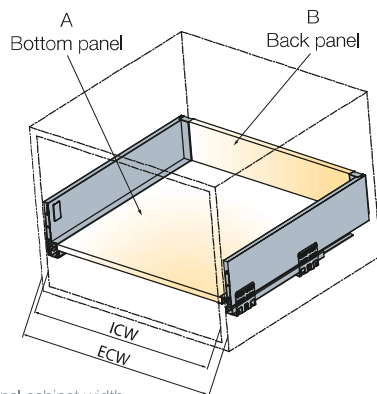



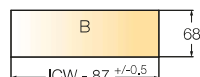
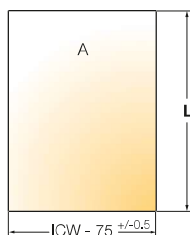



ECW: External cabinet width
ICW: Internal cabinet width
NL: Nominal length of drawer



$$L = NL - 10$$

For further explanation → see page 9

Nominal length (mm)	with EasyFix front connector	with Screw-in front connector		
	Item number for a set	Item number for a set	White	Anthracite grey
270	655.8T27 →	655.8E27 →	150.00	185.00
300*	655.8T30 →	655.8E30 →	150.00	185.00
350	655.8T35 →	655.8E35 →	150.00	185.00
400	655.8T40 →	655.8E40 →	150.00	185.00
450	655.8T45 →	655.8E45 →	150.00	185.00
500	655.8T50 →	655.8E50 →	150.00	185.00
550	655.8T55 →	655.8E55 →	150.00	185.00
One set consists of				
Drawer sides			2 pcs	
Drawer runners			2 pcs	
^Front connectors			2 pcs	
Rear connectors			2 pcs	
Covers			2 pcs	
Mounting instructions			1 pce	

Screws not included. ^Front connectors determined by order code.

- Drawer runner type
- Load capacity
- Minimum height space required
- Wooden back panel thickness
- Wooden bottom panel thickness

Full extension
40kg
115mm
16mm
16mm

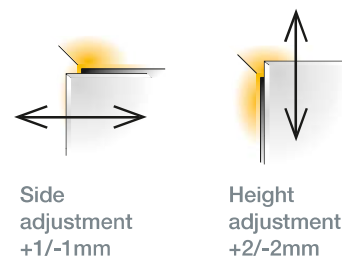

For further explanation → see page 11

Installation dimensions

Minimum space required for the cabinet

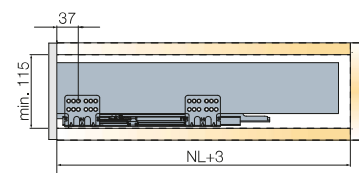

Drilling dimensions for the front panel

EasyFix attachment

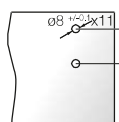

Screw-in attachment

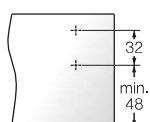

Mounting dimensions for the back panel

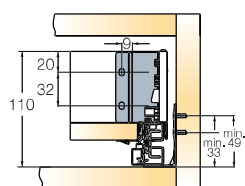

Installation dimensions for the front panel

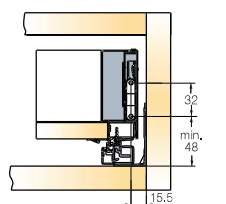

Drawer runner fixing positions

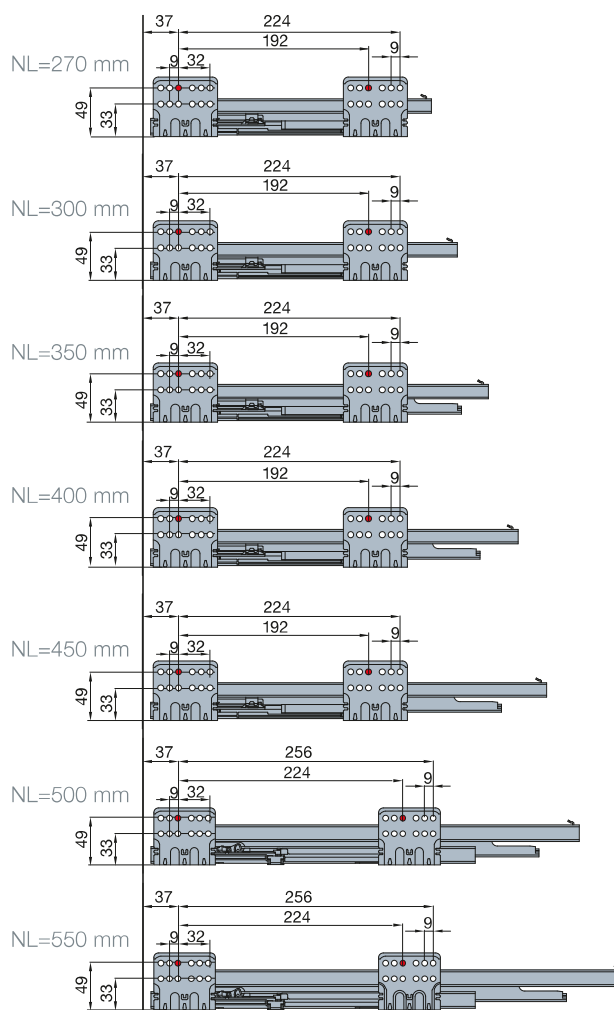
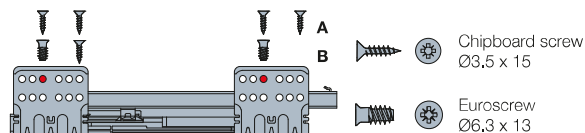

A trial mounting is always recommended. For further information please contact Titus Tekform.
Download supporting documentation from the Titus Tekform website titustekform.com.au

Tekform Slimline Drawer DW100

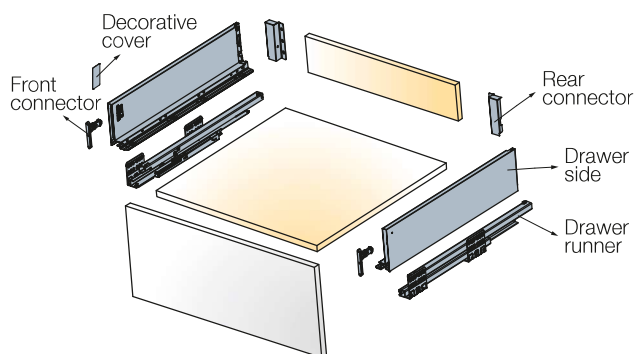
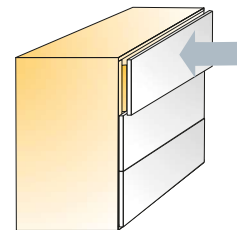

Cutting dimensions details

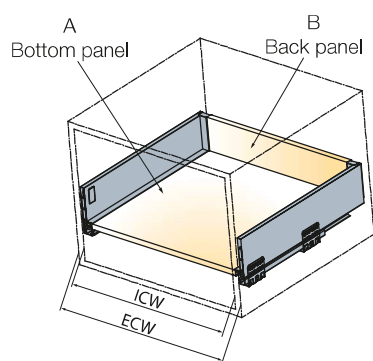



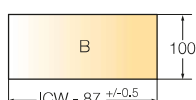
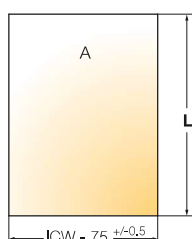



ECW: External cabinet width
ICW: Internal cabinet width
NL: Nominal length of drawer



L=NL-10

For further explanation → see page 9

Nominal length (mm)	with EasyFix front connector	with Screw-in front connector		
	Item number for a set	Item number for a set	White	Anthracite grey
270	655.8U27 →	655.8F27 →	150.00	185.00
300*	655.8U30 →	655.8F30 →	150.00	185.00
350	655.8U35 →	655.8F35 →	150.00	185.00
400	655.8U40 →	655.8F40 →	150.00	185.00
450	655.8U45 →	655.8F45 →	150.00	185.00
500	655.8U50 →	655.8F50 →	150.00	185.00
550	655.8U55 →	655.8F55 →	150.00	185.00
One set consists of				
Drawer sides				2 pcs
Drawer runners				2 pcs
^Front connectors				2 pcs
Rear connectors				2 pcs
Covers				2 pcs
Mounting instructions				1 pce

Screws not included. ^Front connectors determined by order code.

- Drawer runner type
- Load capacity
- Minimum height per drawer required
- Wooden back panel thickness
- Wooden bottom panel thickness

Full extension
40kg
147mm
16mm
16mm

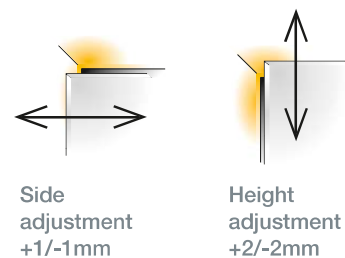

For further explanation → see page 11

Installation dimensions

Minimum space required for the cabinet

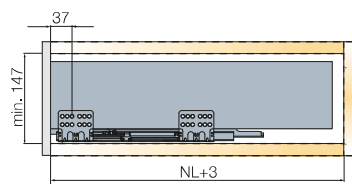

Drilling dimensions for the front panel

EasyFix attachment

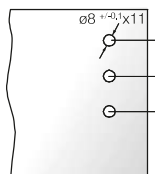

Screw-in attachment

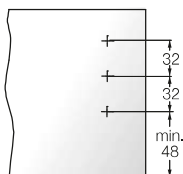

Mounting dimensions for the back panel

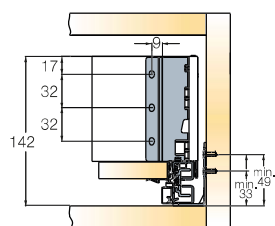

Installation dimensions for the front panel

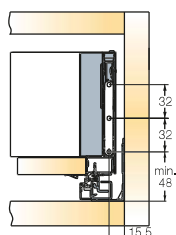

Drawer runner fixing positions

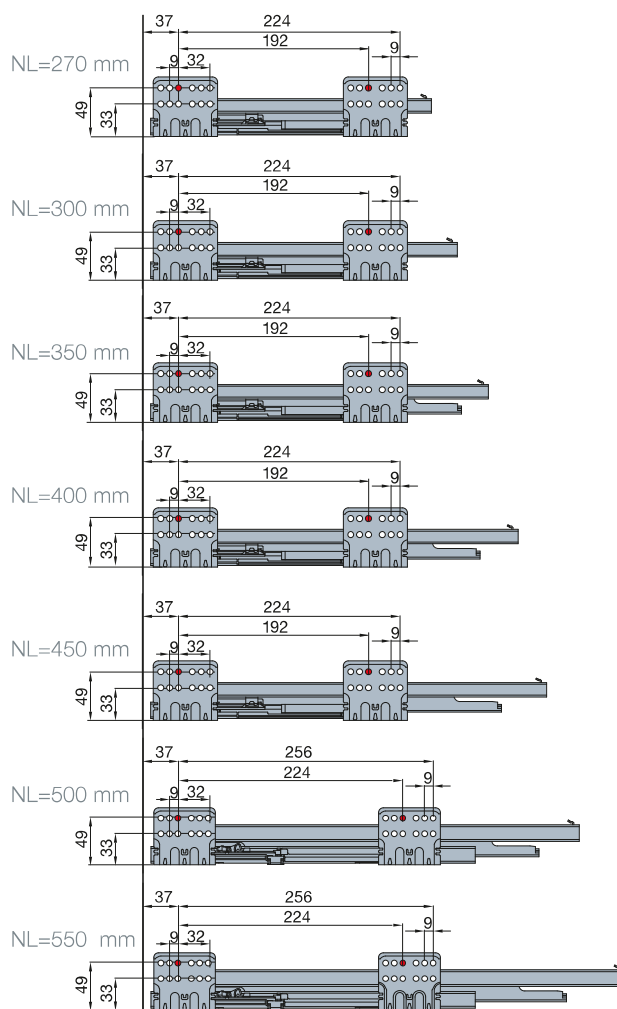
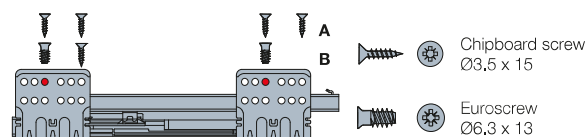

A trial mounting is always recommended. For further information please contact Titus Tekform.
Download supporting documentation from the Titus Tekform website titustekform.com.au

Tekform Slimline Drawer DW145

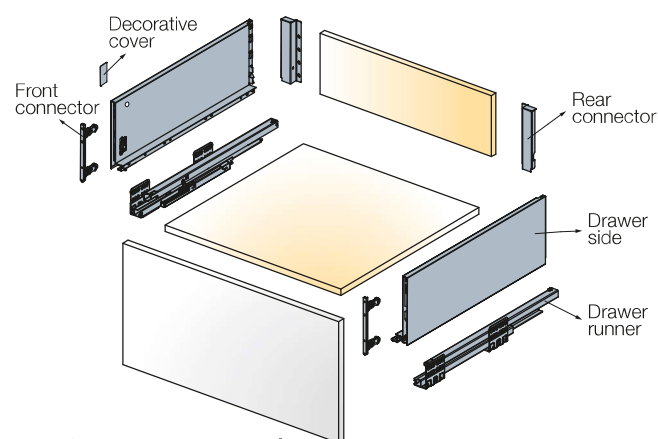
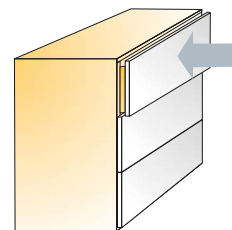

Cutting dimensions details

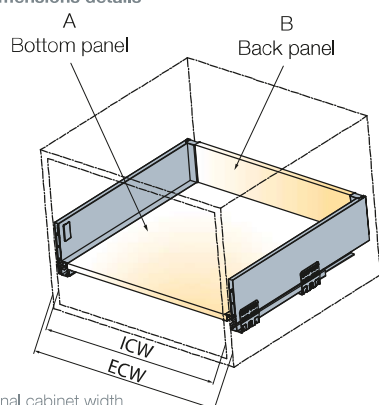



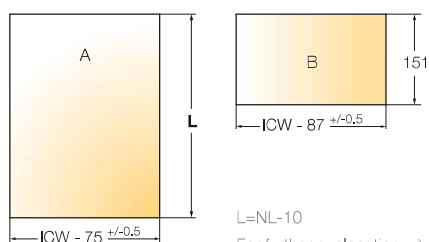



ECW: External cabinet width
ICW: Internal cabinet width
NL: Nominal length of drawer

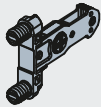
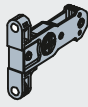

$$L = NL - 10$$

For further explanation → see page 9

Nominal length (mm)	with EasyFix front connector	with Screw-in front connector		
			White	Anthracite grey
	Item number for a set	Item number for a set		
270	655.8V27 →	655.8G27 →	150.00	185.00
300*	655.8V30 →	655.8G30 →	150.00	185.00
350	655.8V35 →	655.8G35 →	150.00	185.00
400	655.8V40 →	655.8G40 →	150.00	185.00
450	655.8V45 →	655.8G45 →	150.00	185.00
500	655.8V50 →	655.8G50 →	150.00	185.00
550	655.8V55 →	655.8G55 →	150.00	185.00
One set consists of				
Drawer sides				2 pcs
Drawer runners				2 pcs
^Front connectors				2 pcs
Rear connectors				2 pcs
Covers				2 pcs
Mounting instructions				1 pce

Screws not included. ^Front connectors determined by order code.

- Drawer runner type
- Load capacity
- Minimum height per drawer required
- Wooden back panel thickness
- Wooden bottom panel thickness

Full extension
40kg
198mm
16mm
16mm

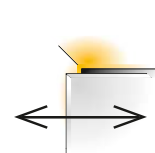

Side
adjustment
+1/-1mm



Height
adjustment
+2/-2mm

For further explanation → see page 11

Installation dimensions

Minimum space required for the cabinet

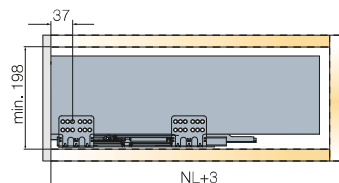

Drilling dimensions for the front panel

EasyFix attachment

Screw-in attachment

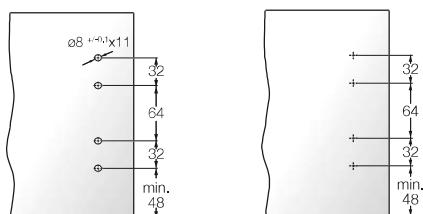

Mounting dimensions for the back panel

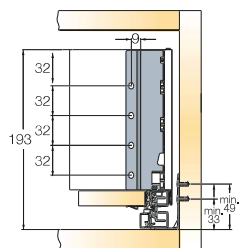

Installation dimensions for the front panel

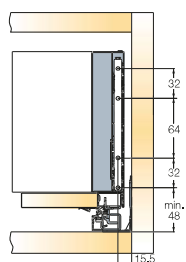

Drawer runner fixing positions

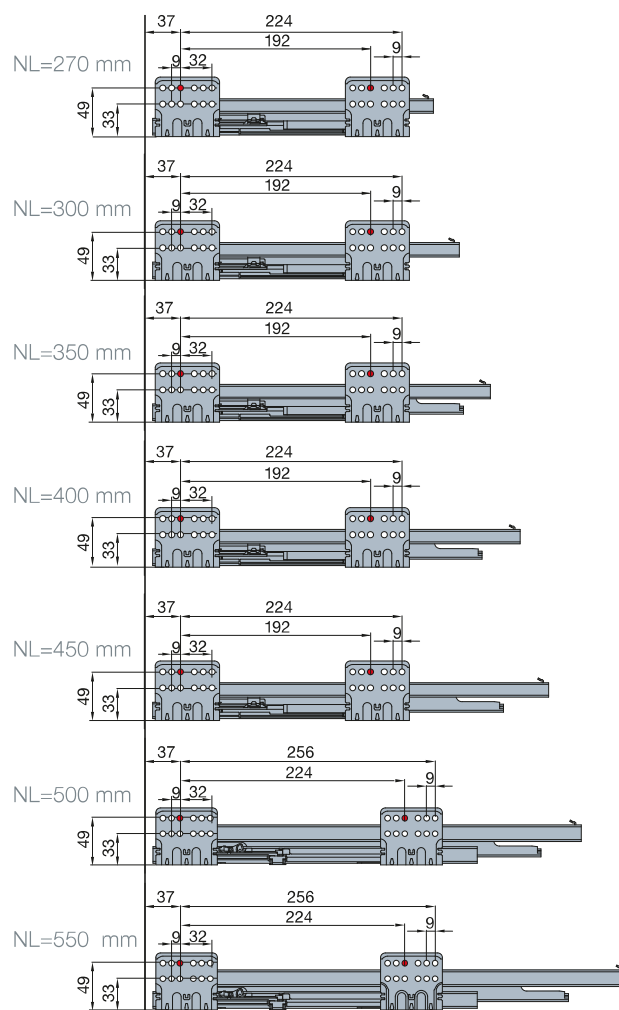
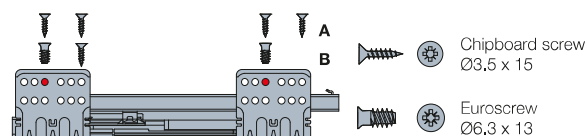

A trial mounting is always recommended. For further information please contact Titus Tekform.
Download supporting documentation from the Titus Tekform website titustekform.com.au

Tekform Slimline Drawer DW182

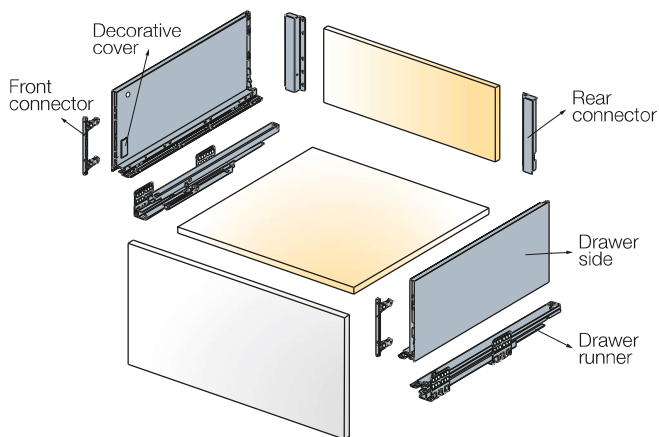
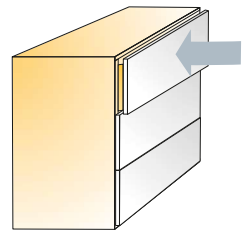



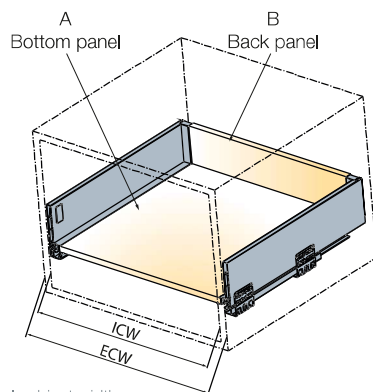

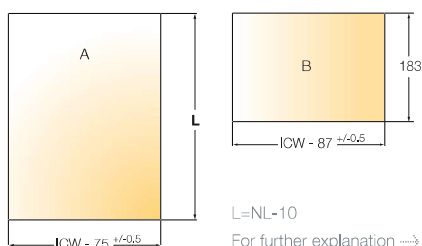

Cutting dimensions details



ECW: External cabinet width
ICW: Internal cabinet width
NL: Nominal length of drawer



Nominal length (mm)	with EasyFix front connector	with Screw-in front connector		
	Item number for a set	Item number for a set	White	Antracite grey
270	655.8Z27 →	655.8H27 →	150.00	185.00
300*	655.8Z30 →	655.8H30 →	150.00	185.00
350	655.8Z35 →	655.8H35 →	150.00	185.00
400	655.8Z40 →	655.8H40 →	150.00	185.00
450	655.8Z45 →	655.8H45 →	150.00	185.00
500	655.8Z50 →	655.8H50 →	150.00	185.00
550	655.8Z55 →	655.8H55 →	150.00	185.00
One set consists of				
Drawer sides				2 pcs
Drawer runners				2 pcs
^Front connectors				2 pcs
Rear connectors				2 pcs
Covers				2 pcs
Mounting instructions				1 pce

Screws not included. ^Front connectors determined by order code.

- Drawer runner type
- Load capacity
- Minimum height per drawer required
- Wooden back panel thickness
- Wooden bottom panel thickness

Full extension
40kg
230mm
16mm
16mm

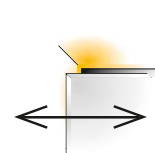

Side
adjustment
+1/-1mm



Height
adjustment
+2/-2mm

For further explanation → see page 11

Installation dimensions

Drawer runner fixing positions

Minimum space required for the cabinet

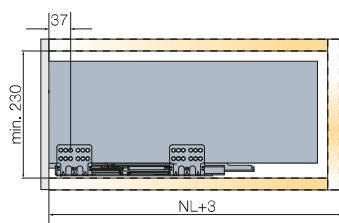

Drilling dimensions for the front panel

EasyFix attachment

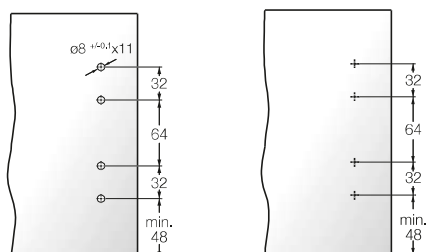

Screw-in attachment

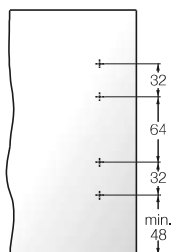

Mounting dimensions for the back panel

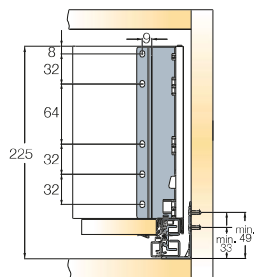

Installation dimensions for the front panel

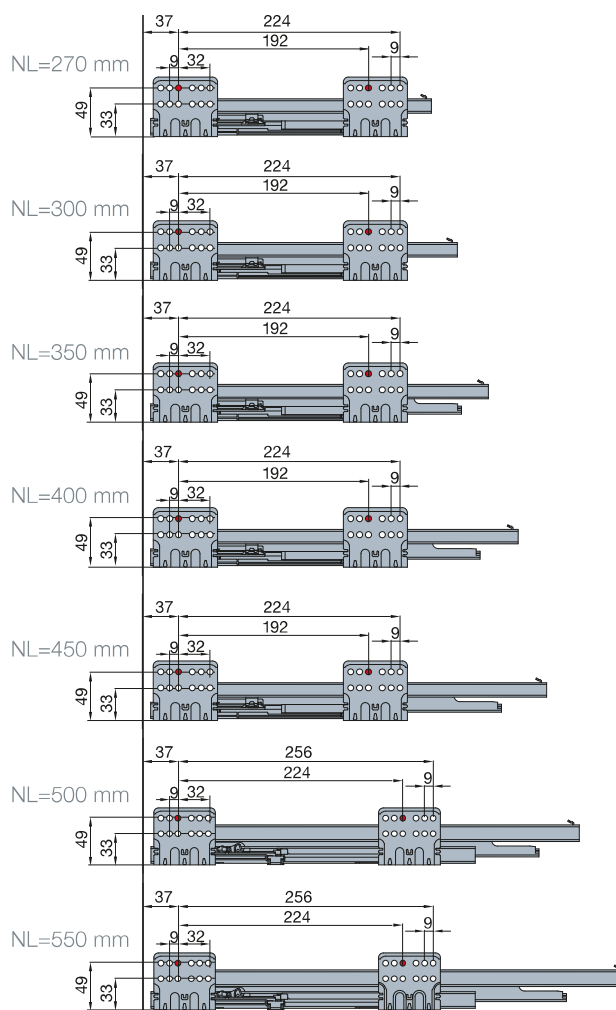
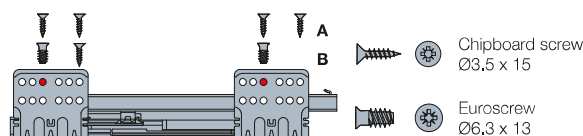
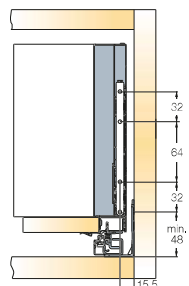

A trial mounting is always recommended. For further information please contact Titus Tekform.
Download supporting documentation from the Titus Tekform website titustekform.com.au

Inner Drawer Front for Tekform Slimline Drawer DW70

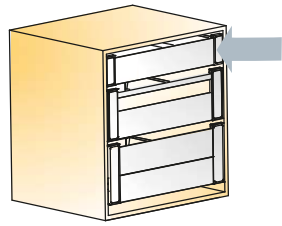

Inner drawer front, assembly set



Made of aluminium and plastic

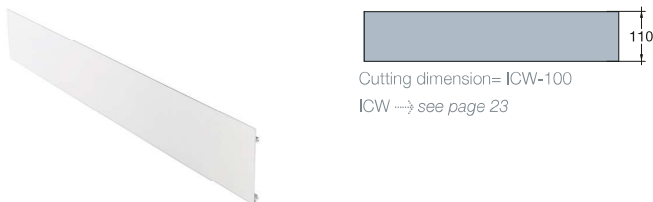

Cutting dimension= ICW-100
ICW see page 23

Made of aluminium

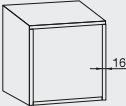

Made of aluminium and plastic

External cabinet width (mm)	Cabinet side thickness=16mm		
		White	Anthracite grey
400	655.8177 →→	511.00	515.00
450	655.8178 →→	511.00	515.00
500	655.8179 →→	511.00	515.00
600	655.8180 →→	511.00	515.00
800	655.8181 →→	511.00	515.00
900	655.8182 →→	511.00	515.00
1000	655.8183 →→	511.00	515.00
1200	655.8184 →→	511.00	515.00
600	655.8185 →→	511.00	515.00
800	655.8186 →→	511.00	515.00
900	655.8187 →→	511.00	515.00
1000	655.8188 →→	511.00	515.00
1200	655.8189 →→	511.00	515.00
	655.8065 →→	150.00	185.00



Bottom panel support

650.8908.350 white

650.8908.385 grey

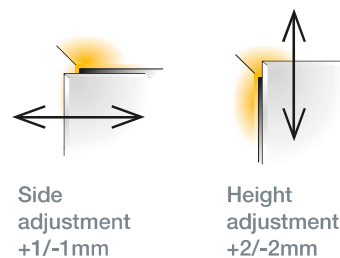
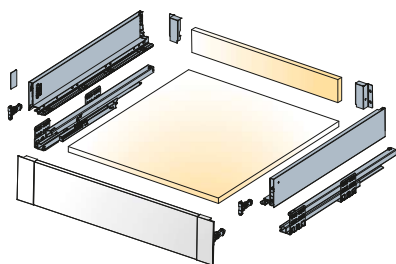

For further explanation → see page 11-12

Installation dimensions

Drawer runner fixing positions

Minimum space required for the cabinet

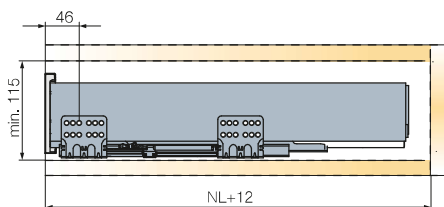

Cutting dimensions details

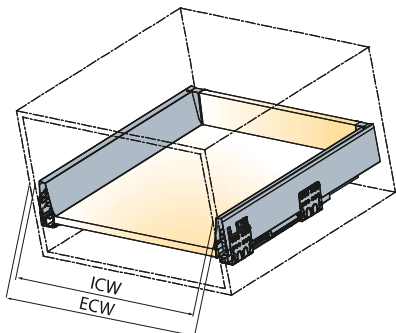

ECW: External cabinet width
ICW: Internal cabinet width
NL: Nominal length of drawer

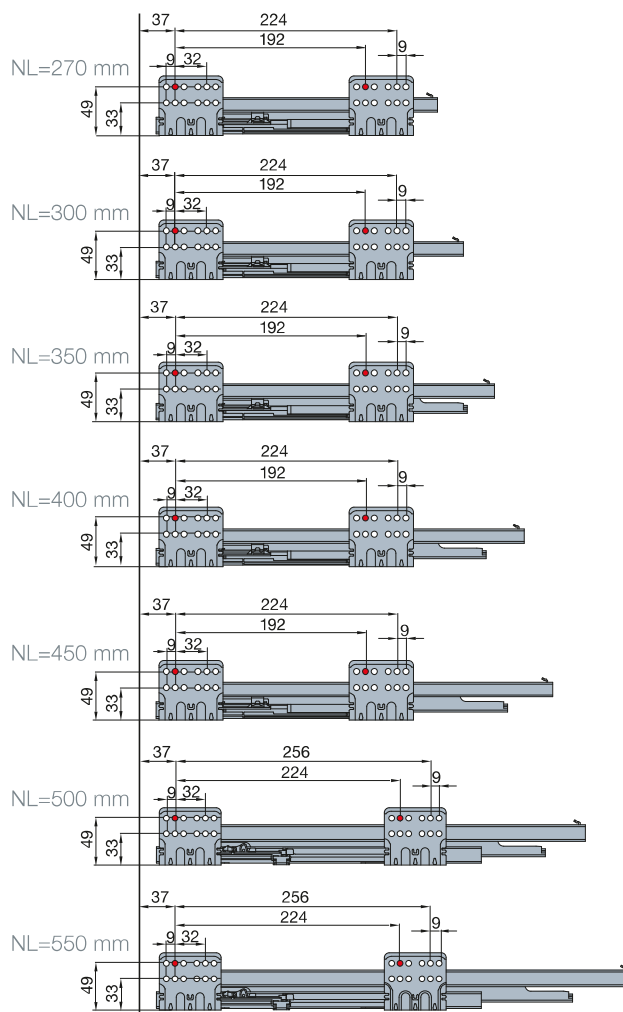
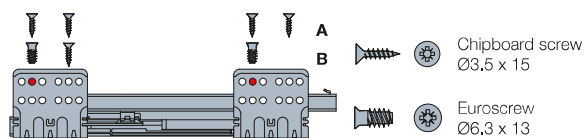

Inner Drawer Front for Tekform Slimline Drawer DW70 with Glass

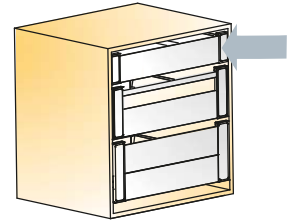

Inner drawer front, assembly set

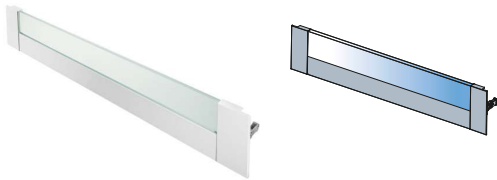

Made of aluminium and glass

Front panel

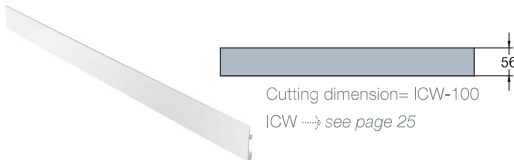

Made of aluminium

Low glass

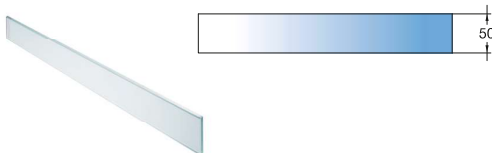

Made of glass

Front bracket



Made of aluminium and plastic

External cabinet width (mm)	Cabinet side thickness=16mm 				
		White	Anthracite grey	Frosted glass	Transparent glass
Item number					
400	655.8306 →	511.00	515.00		
450	655.8307 →	511.00	515.00		
500	655.8308 →	511.00	515.00		
600	655.8285 →	511.00	515.00		
800	655.8286 →	511.00	515.00		
900	655.8287 →	511.00	515.00		
1000	655.8288 →	511.00	515.00		
1200	655.8289 →	511.00	515.00		
600	655.8205 →	511.00	515.00		
800	655.8206 →	511.00	515.00		
900	655.8207 →	511.00	515.00		
1000	655.8208 →	511.00	515.00		
1200	655.8209 →	511.00	515.00		
600	655.8295 →			391.00	392.00
800	655.8296 →			391.00	392.00
900	655.8297 →			391.00	392.00
1000	655.8298 →			391.00	392.00
1200	655.8299 →			391.00	392.00
655.8305 →		150.00	185.00		



Bottom panel support

650.8908.350 white
650.8908.385 grey

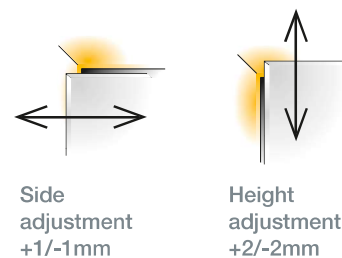
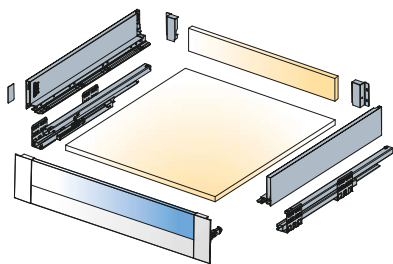

For further explanation → see page 11-12

Installation dimensions

Drawer runner fixing positions

Minimum space required for the cabinet

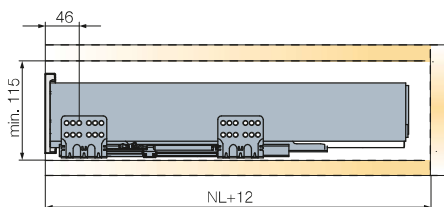

Cutting dimensions details

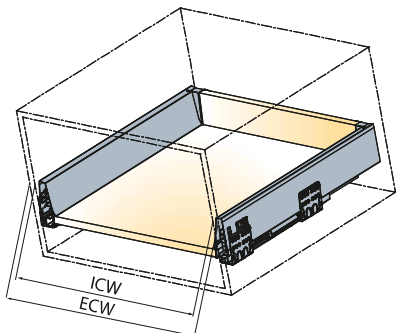

ECW: External cabinet width
ICW: Internal cabinet width
NL: Nominal length of drawer

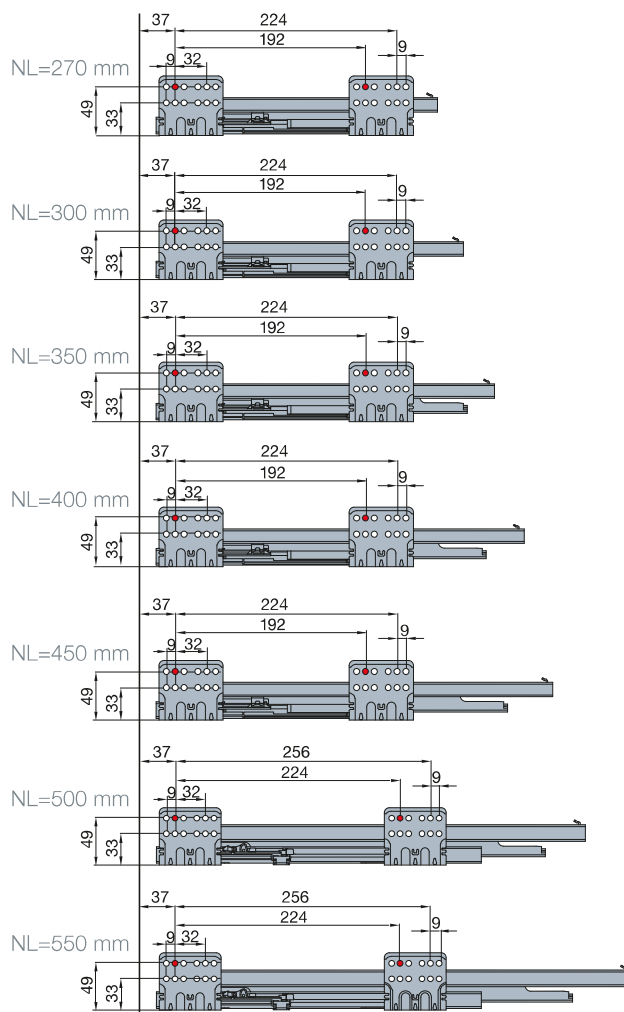
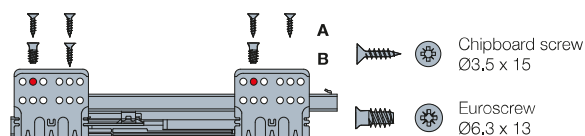

Inner Drawer Front for Tekform Slimline Drawer DW145 with Bar

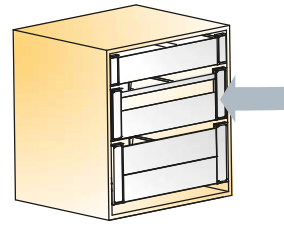

Inner drawer front, assembly set

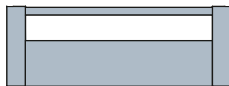

Made of aluminium and plastic

Front bar



Made of aluminium

Front panel

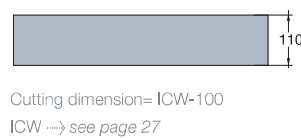
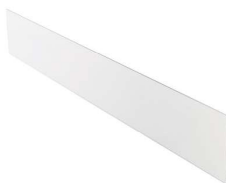

Made of aluminium

Front bracket



Made of aluminium and plastic

External cabinet width (mm)	Cabinet side thickness=16mm			
			White	Anthractive grey
Item number				
400	655.8309 →		511.00	515.00
450	655.8310 →		511.00	515.00
500	655.8311 →		511.00	515.00
600	655.8190 →		511.00	515.00
800	655.8191 →		511.00	515.00
900	655.8192 →		511.00	515.00
1000	655.8193 →		511.00	515.00
1200	655.8194 →		511.00	515.00
600	655.8210 →		511.00	515.00
800	655.8211 →		511.00	515.00
900	655.8212 →		511.00	515.00
1000	655.8213 →		511.00	515.00
1200	655.8214 →		511.00	515.00
600	655.8185 →		511.00	515.00
800	655.8186 →		511.00	515.00
900	655.8187 →		511.00	515.00
1000	655.8188 →		511.00	515.00
1200	655.8189 →		511.00	515.00
	655.8101 →		350.00	385.00



Bottom panel support

650.8908.350 white
650.8908.385 grey

Inner Drawer Front for Tekform Slimline Drawer DW145 with Glass

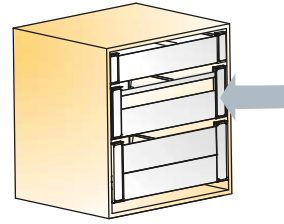

Inner drawer front, assembly set

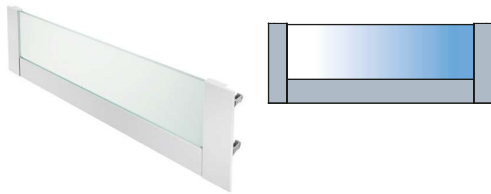

Made of aluminium and glass

Front panel

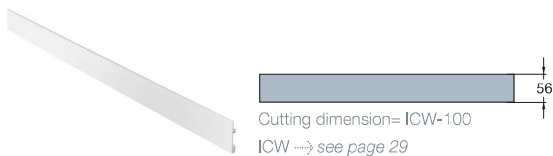

Made of aluminium

Front glass panel - high

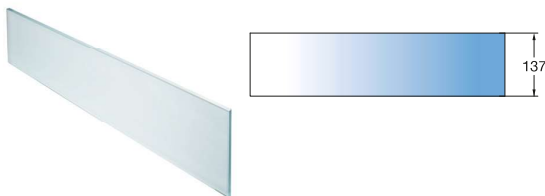

Made of glass

Front bracket



Made of aluminium and plastic

External cabinet width (mm)	Cabinet side thickness=16mm 				
		White	Anthracite grey	Frosted glass	Transparent glass
Item number					
400	655.8312 →	511.00	515.00		
450	655.8313 →	511.00	515.00		
500	655.8314 →	511.00	515.00		
600	655.8200 →	511.00	515.00		
800	655.8201 →	511.00	515.00		
900	655.8202 →	511.00	515.00		
1000	655.8203 →	511.00	515.00		
1200	655.8204 →	511.00	515.00		
600	655.8205 →	511.00	515.00		
800	655.8206 →	511.00	515.00		
900	655.8207 →	511.00	515.00		
1000	655.8208 →	511.00	515.00		
1200	655.8209 →	511.00	515.00		
600	655.8220 →			391.00	392.00
800	655.8221 →			391.00	392.00
900	655.8222 →			391.00	392.00
1000	655.8223 →			391.00	392.00
1200	655.8224 →			391.00	392.00
520	655.8103 →	350.00	385.00		



Bottom panel support

650.8908.350 white
650.8908.385 grey

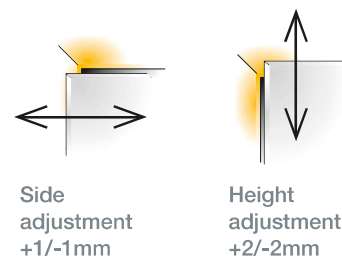
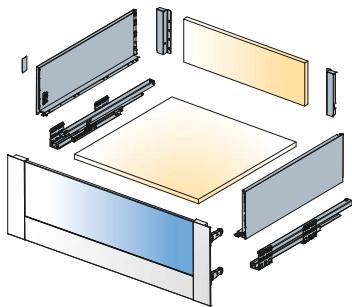

For further explanation → see page 11-12

Installation dimensions

Drawer runner fixing positions

Minimum space required for the cabinet

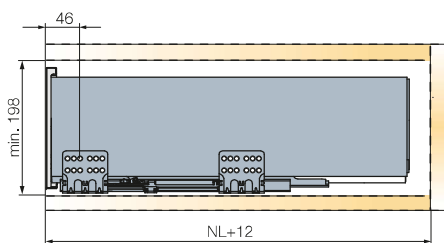

Cutting dimensions details

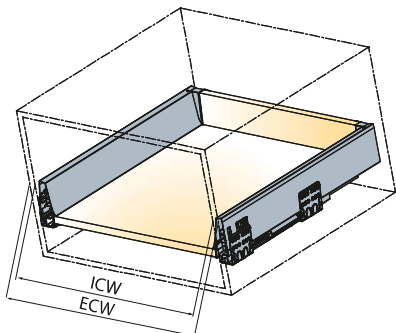

ECW: External cabinet width
ICW: Internal cabinet width
NL: Nominal length of drawer

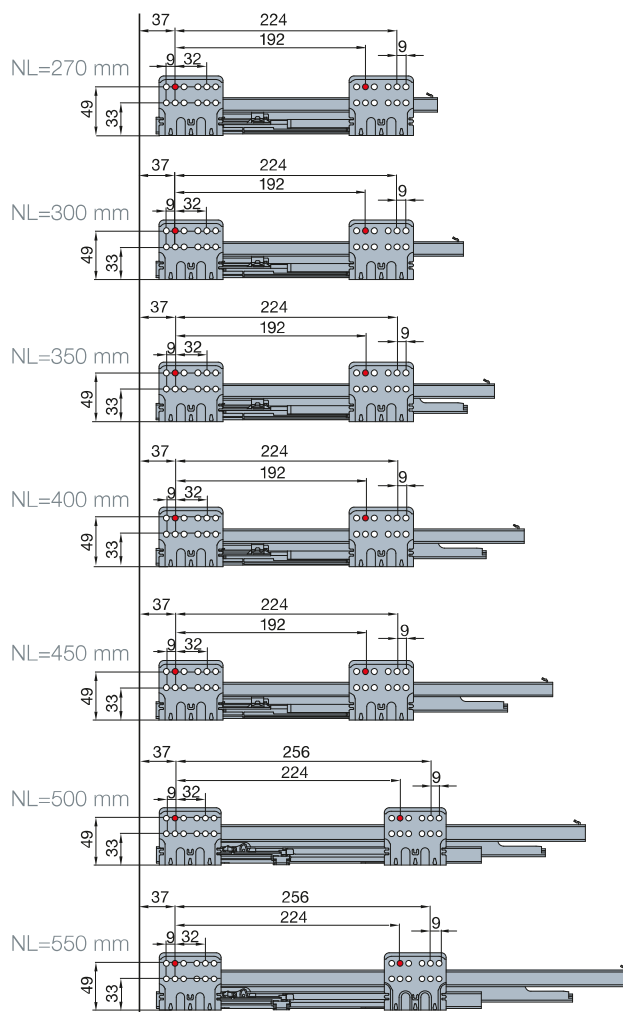
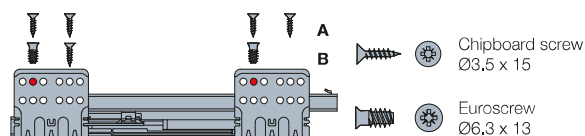

Inner Drawer Front for Tekform Slimline Drawer DW182 with Bar

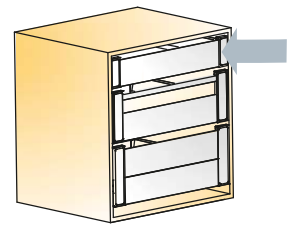

Inner drawer front, assembly set

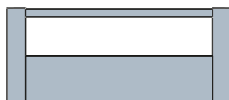

Made of aluminium and plastic

Front bar



Cutting dimension= ICW-88
ICW → see page 31

Made of aluminium

Front panel

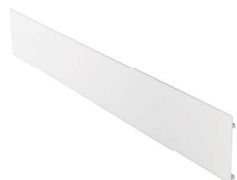

Cutting dimension= ICW-100
ICW → see page 31

Made of aluminium

Front bracket

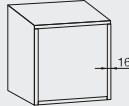

Made of aluminium and plastic

External cabinet width (mm)	Cabinet side thickness=16mm			
			White	Anthracite grey
	Item number			
400	655.8315 →		511.00	515.00
450	655.8316 →		511.00	515.00
500	655.8317 →		511.00	515.00
600	655.8260 →		511.00	515.00
800	655.8261 →		511.00	515.00
900	655.8262 →		511.00	515.00
1000	655.8263 →		511.00	515.00
1200	655.8264 →		511.00	515.00
600	655.8210 →		511.00	515.00
800	655.8211 →		511.00	515.00
900	655.8212 →		511.00	515.00
1000	655.8213 →		511.00	515.00
1200	655.8214 →		511.00	515.00
600	655.8185 →		511.00	515.00
800	655.8186 →		511.00	515.00
900	655.8187 →		511.00	515.00
1000	655.8188 →		511.00	515.00
1200	655.8189 →		511.00	515.00
	655.8170 →		350.00	385.00



Bottom panel support

650.8908.350 white
650.8908.385 grey

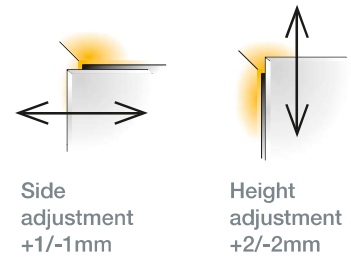
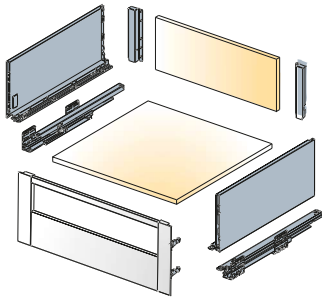

For further explanation → see page 11-12

Installation dimensions

Drawer runner fixing positions

Minimum space required for the cabinet

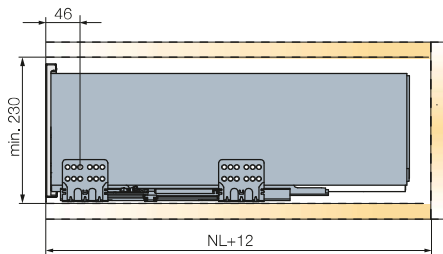

Cutting dimensions details

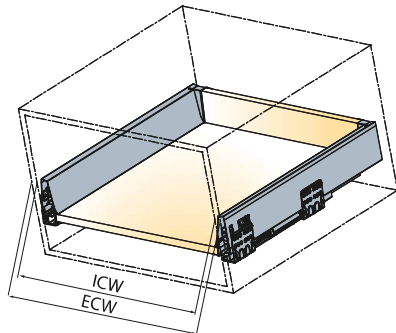

ECW: External cabinet width
ICW: Internal cabinet width
NL: Nominal length of drawer

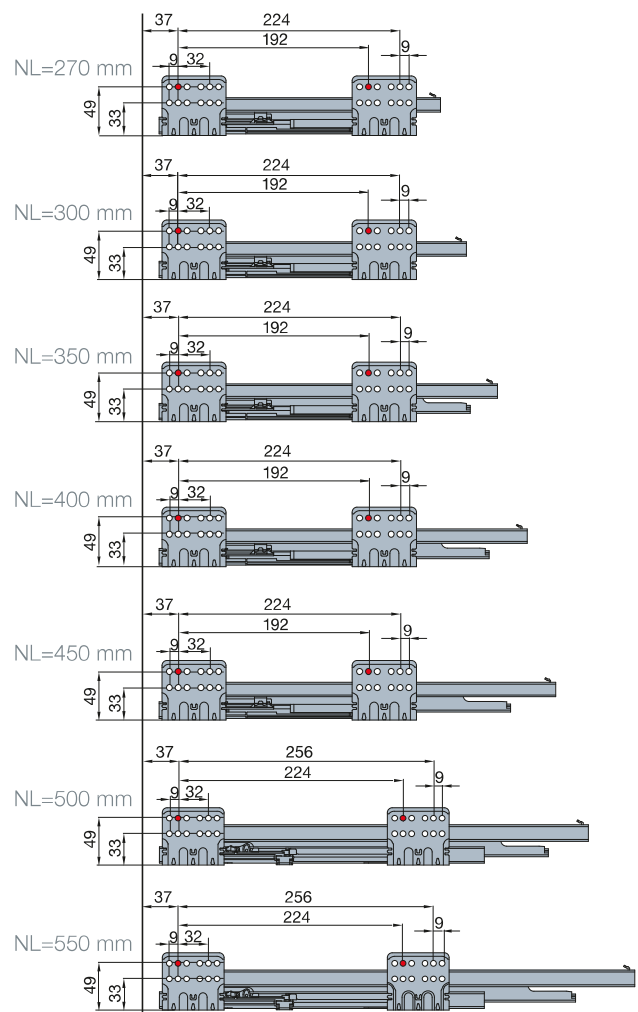
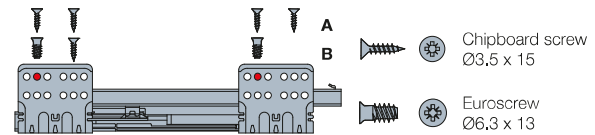

Inner Drawer Front for Tekform Slimline Drawer DW182 with Glass

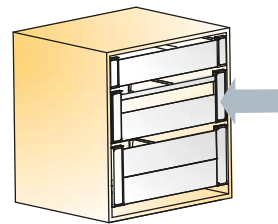

Inner drawer front, assembly set

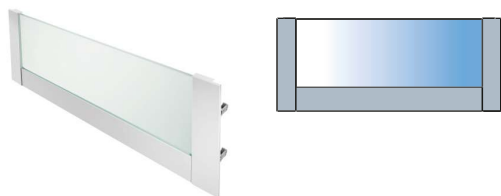

Made of aluminium and glass

Front panel

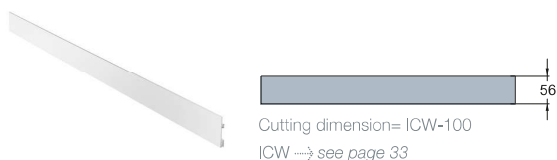

Cutting dimension= ICW-100
ICW → see page 33

Made of aluminium

Front glass panel - high

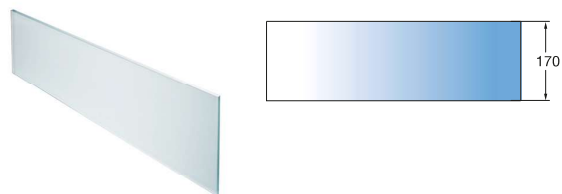

Made of glass

Front bracket

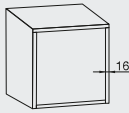

Made of aluminium and plastic

External cabinet width (mm)	Cabinet side thickness=16mm 				
		White	Anthracite grey	Frosted glass	Transparent glass
Item number					
400	655.8321 →	511.00	515.00		
450	655.8322 →	511.00	515.00		
500	655.8323 →	511.00	515.00		
600	655.8270 →	511.00	515.00		
800	655.8271 →	511.00	515.00		
900	655.8272 →	511.00	515.00		
1000	655.8273 →	511.00	515.00		
1200	655.8274 →	511.00	515.00		
600	655.8205 →	511.00	515.00		
800	655.8206 →	511.00	515.00		
900	655.8207 →	511.00	515.00		
1000	655.8208 →	511.00	515.00		
1200	655.8209 →	511.00	515.00		
600	655.8280 →			391.00	392.00
800	655.8281 →			391.00	392.00
900	655.8282 →			391.00	392.00
1000	655.8283 →			391.00	392.00
1200	655.8284 →			391.00	392.00
	655.8172 →	350.00	385.00		



Bottom panel support

650.8908.350 white
650.8908.385 grey

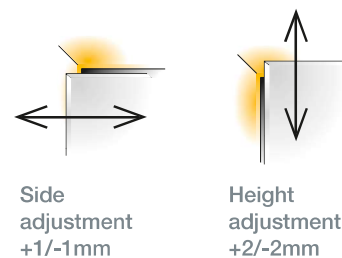
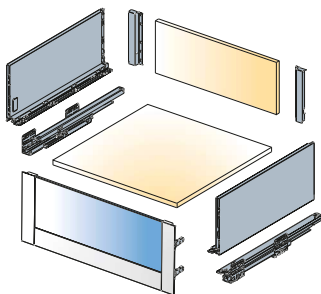

For further explanation → see page 11-12

Installation dimensions

Drawer runner fixing positions

Minimum space required for the cabinet

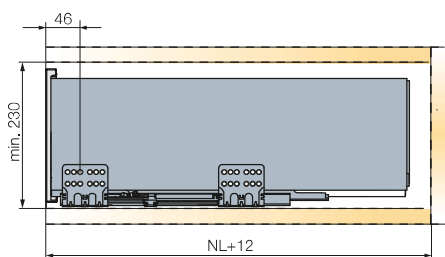

Cutting dimensions details

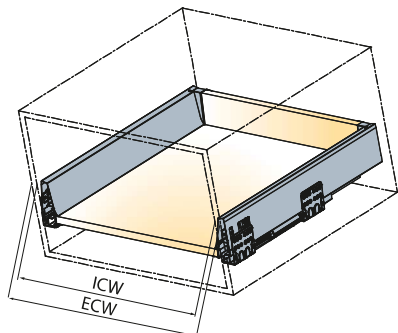

ECW: External cabinet width
ICW: Internal cabinet width
NL: Nominal length of drawer

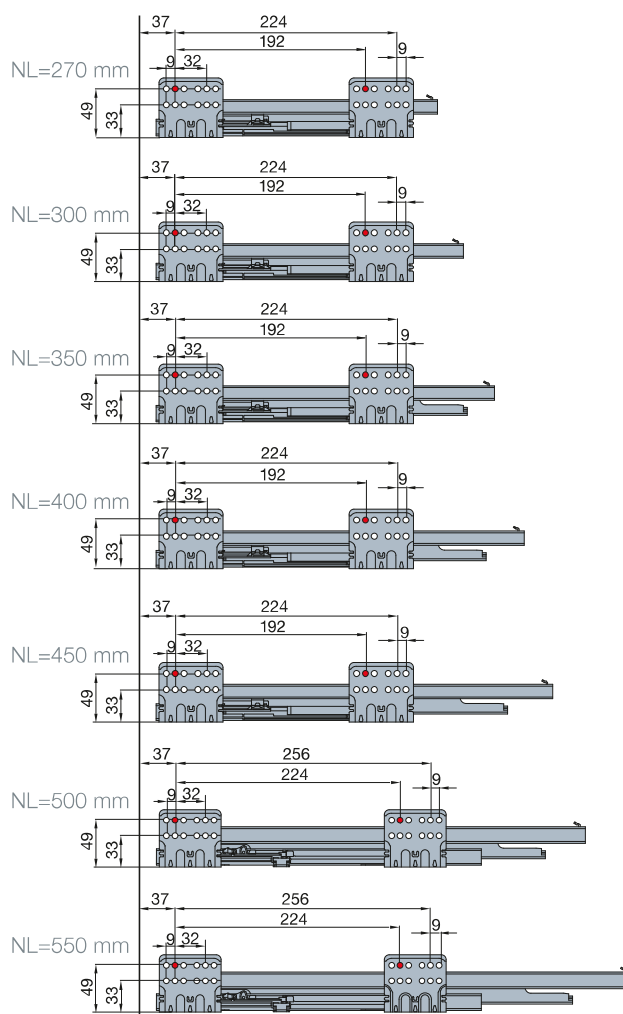
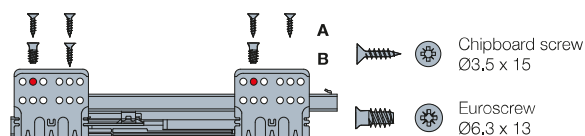

Assembly Instructions



Screws are not included

Assembly Sequence

Connect the drawer sides to the bottom panel (1) and fix it with screws (2)

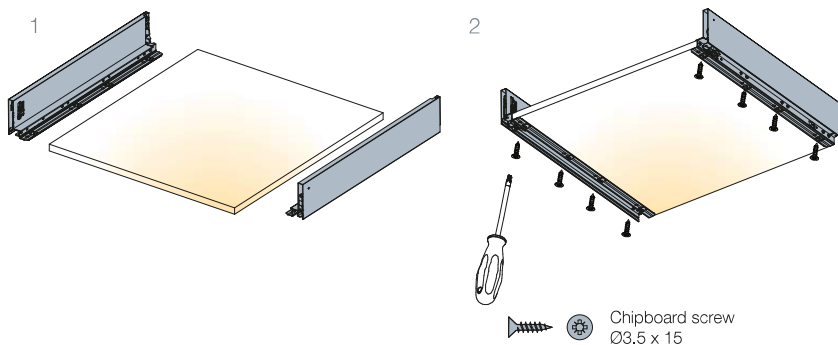

Insert the rear connector vertically (3) and push it downwards into recess in the drawer side (4)

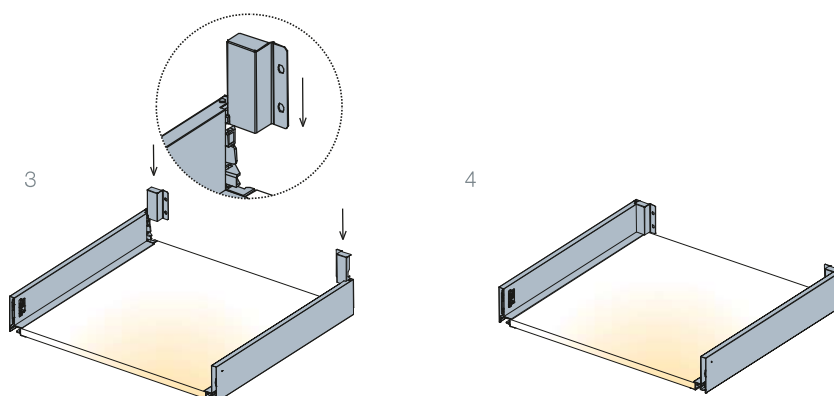

Insert the back panel (5) and fix it with screws (6)

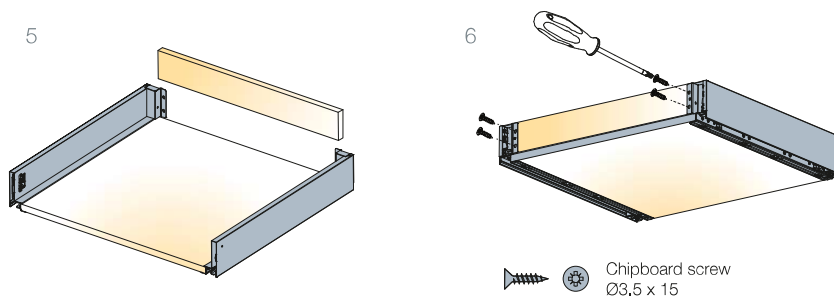

 Screws are not included

Insertion of Front Connectors

EasyFix

Insert the front connectors into holes on the front panel

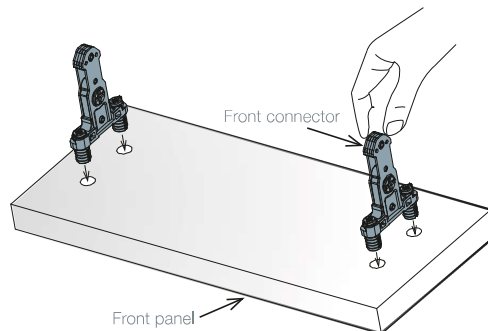

Turn the screws 90° into locked position

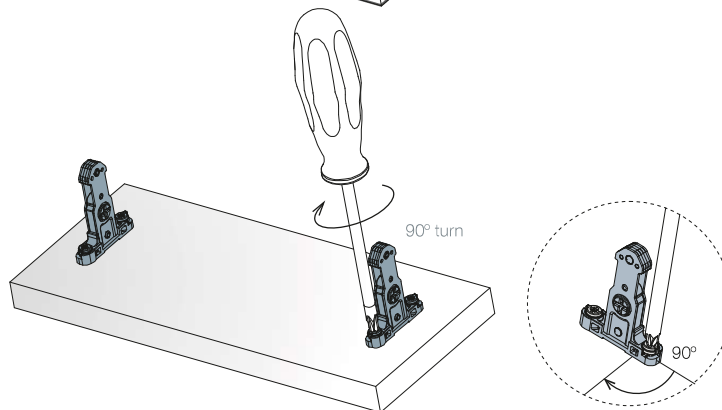

Screw-in fixing

Use Ø3 x 15mm screws for fixing

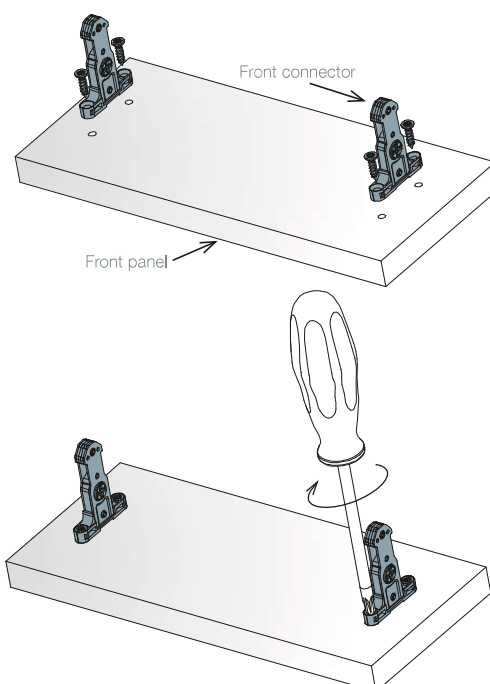

 Chipboard screw
Ø3.5 x 15

Assembly Instructions

Front Panel Mounting / Removal

Mounting

Attach the front panel to the drawer and press to click

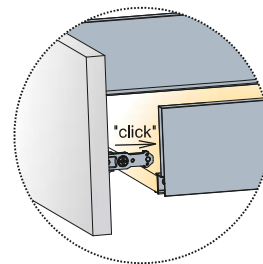
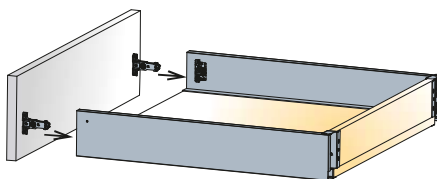

Removal

Turn the screw towards the front panel

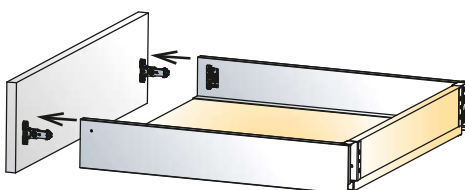
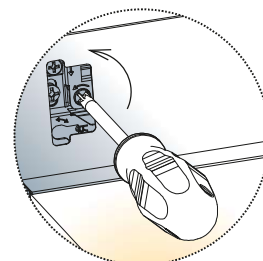
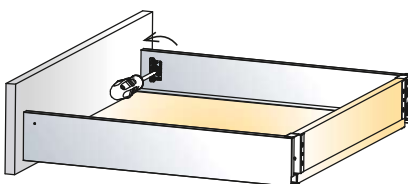

Drawer Insertion / Removal

Insertion

Place the drawer horizontally on the runners and push towards the cabinet until you hear the drawer is locked

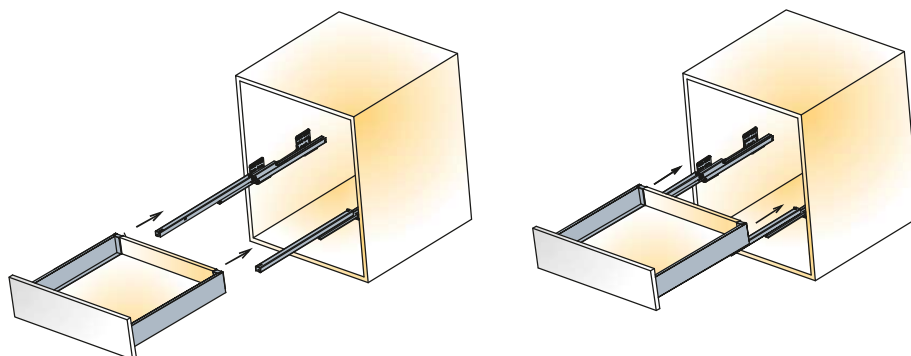

Push to fully close

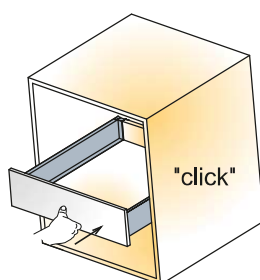

Removal

Press-up the button under the drawer. Keep pressed to pull the drawer out

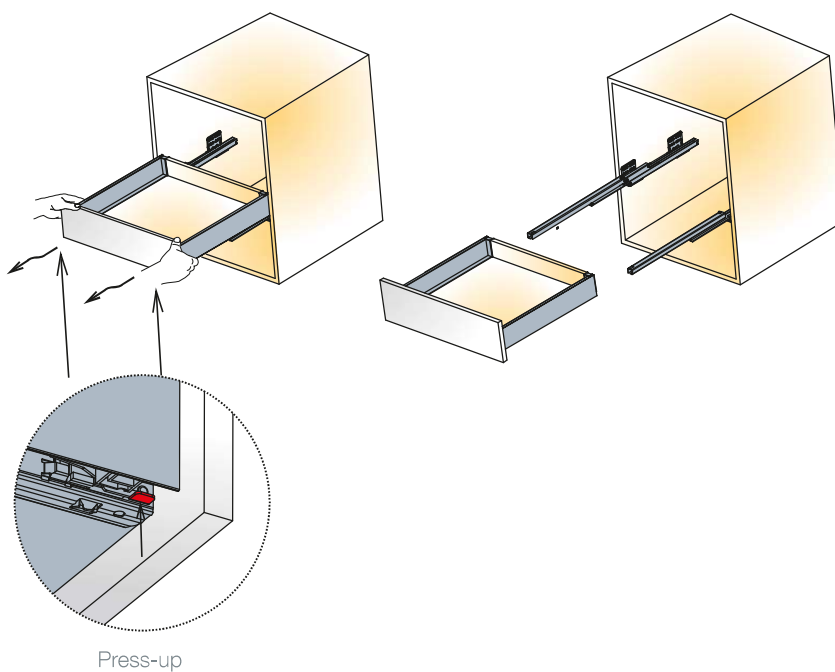

Accessories Mounting

Assembly of Inner Drawer Front

Slimline DW70

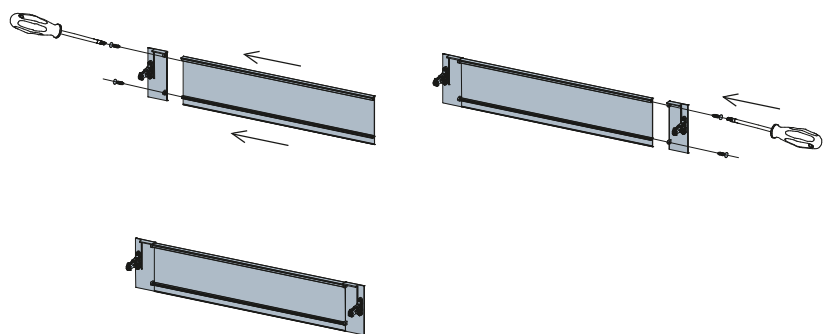

Slimline DW145 and DW182
with bar

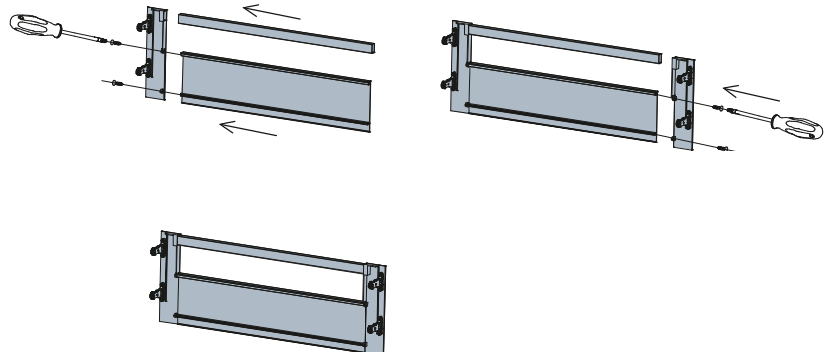

Slimline DW70, DW145 and
DW182 with glass

